

04.-08.08.2012

Olympiade 2012 in London

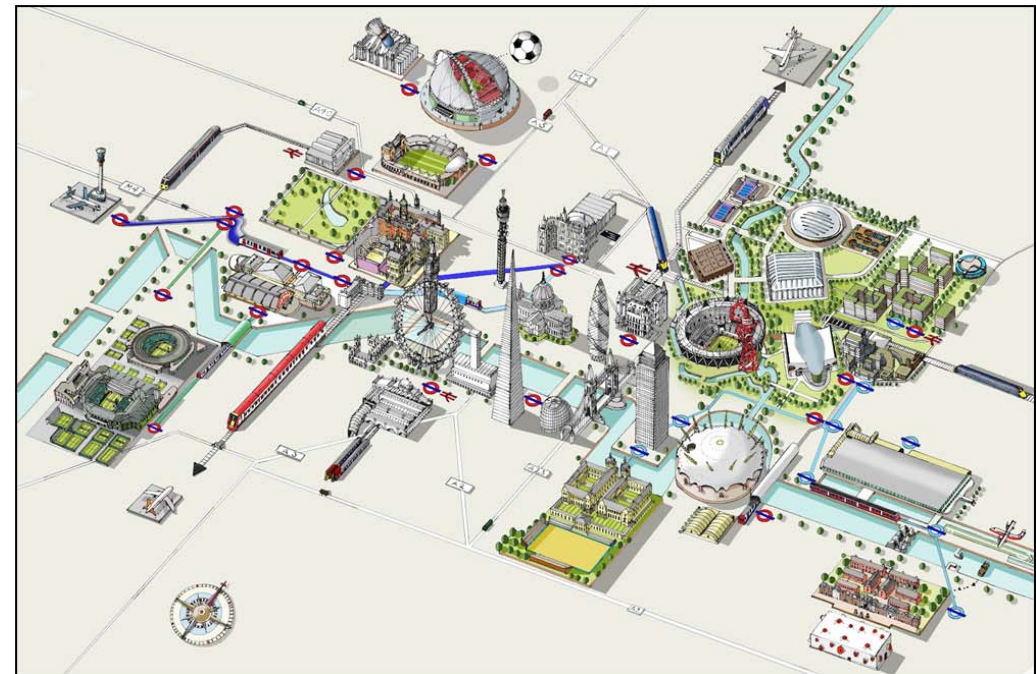





Malthouse Avenue Cardiff Gate
Business Park Pontprennau
CF238RA - CARDIFF
UNITED KINGDOM
Tel.: [\(+44\)2920/733222](tel:+442920733222)
Fax.: [\(+44\)2920/734222](tel:+442920734222)
Telefonische Buchung: (+44)

ab
£ 35.00¹

VERFÜGBARKEITEN ANZEIGEN 



ALLE FOTOS UND VIDEOS ►





A stylized, high-contrast illustration of a building, likely the former courthouse mentioned in the text. The building is rendered in shades of blue and white, set against a background of green and yellow diagonal stripes. The illustration is framed by a black border.

clink
clinkhostel.com

Judge for yourself...

Stay in a former courthouse
See where The Clash went on trial
Sleep in a real police cell
Explore London from a great location

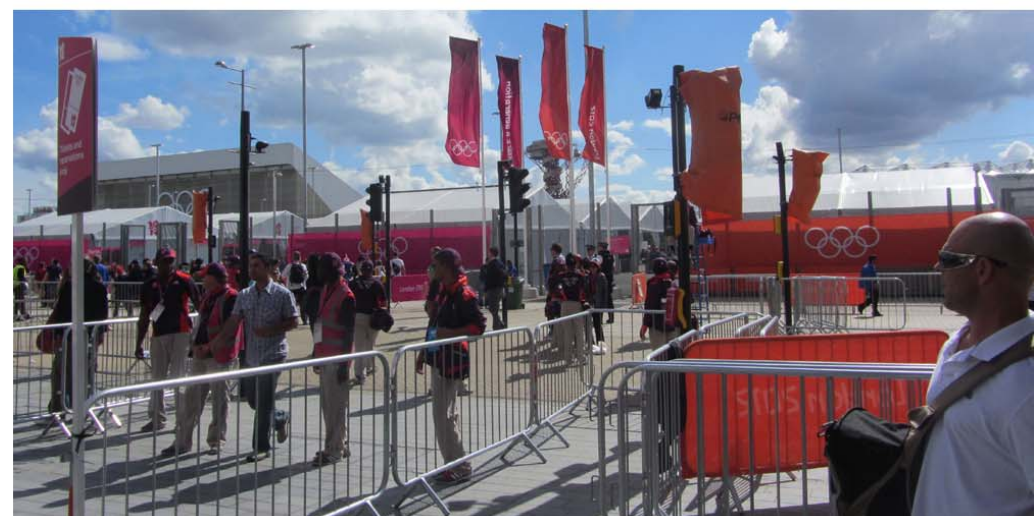











THE OFFICIAL RESIDENCES OF THE QUEEN  THE OFFICIAL RESIDENCE OF THE PRINCE OF WALES

BUCKINGHAM PALACE

Summer Opening of the State Rooms

Please present at the Ticket Holders' Entrance

on **MONDAY**
06-AUGUST-2012

at **11:30**

Adult £18.00

Booking Reference: 6091671 / A285 (Gift Aid Ref.) Not for resale



